

SCAMBIATORI ARIA/OLIO - AIR/OIL COOLERS



**ACCIAIO/RAME
STEEL/COPPER**

FC ACCIAIO/RAME - STEEL/COPPER							
Tipo Type	Portata olio Oil flow capacity lt. min-max	Capacità di scambio Heat exchange capacity Kcal/h	Ventola Fan Ø mm.	Bar	IP	dba	Kg
FC 15-50	5-50	30° 1806/2322 40° 2408/3096 50° 3010/3870	190	15	67	68	3
FC 30-60	10-90	30° c 3350-4386 40° c 4472-5848 50° c 5590-7310	280	15	68	74	9
FC 45-90	25-150	30° c 3870-5160 40° c 5160-6880 50° c 6450-8600	280	15	68	74	12
FC 55-110	25-170	30° c 4650-6192 40° c 6192-8256 50° c 7740-10320	305	15	67	74	18
FC 60-120	30-190	30° c 4650-5950 40° c 6192-7912 50° c 7740-9890	280	15	30	74	16
FC 50-100	10-100	30° c 7224-8514 40° c 9632-11352 50° c 12050-14190	305	15	68	75	23
FC 60-200/2V biventola	25-200	30° c 7224-10578 40° c 9632-14104 50° c 12050-17650	280x2	15	68	74	25
FC 50-200	25-150	30° c 7740-11094 40° c 10320-14792 50° c 12900-18490	385	15	68	79	31

FC 15-50

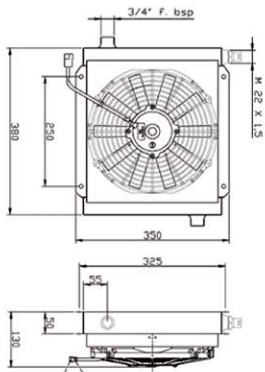

FC 45-90

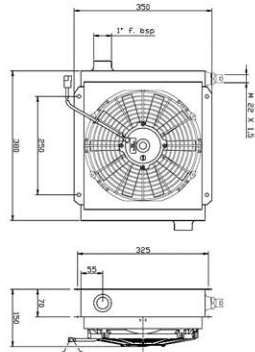

FC 55-110

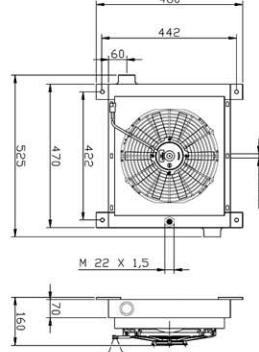

FC 60-120

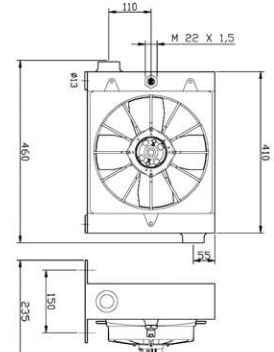

FC 30-60

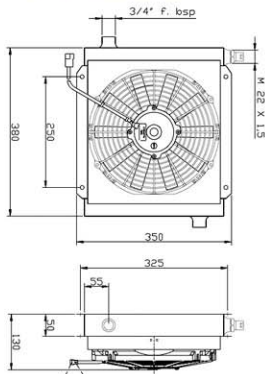

FC 50-100

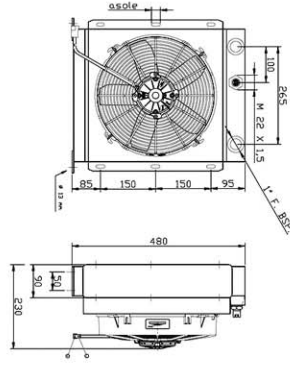

FC 60-120/2V

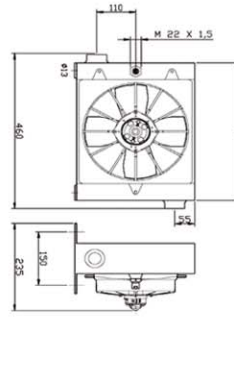

FC 50-200

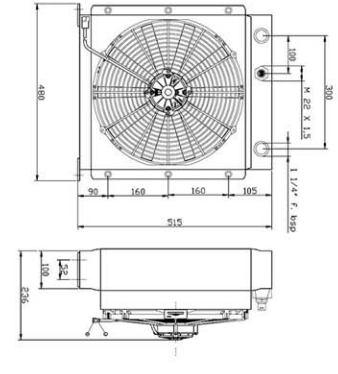

* Le specifiche tecniche e le dimensioni riportate non sono impegnative, e Ferrari International 2 si riserva il diritto di apportare le modifiche che dovessero manifestarsi necessarie senza preavviso.
* The specifications and dimensions indicated are not binding; Ferrari International 2, therefore, reserves the right to make changes at any time.