

Air/Oil Cools Technical Characteristics and Mounting Instructions

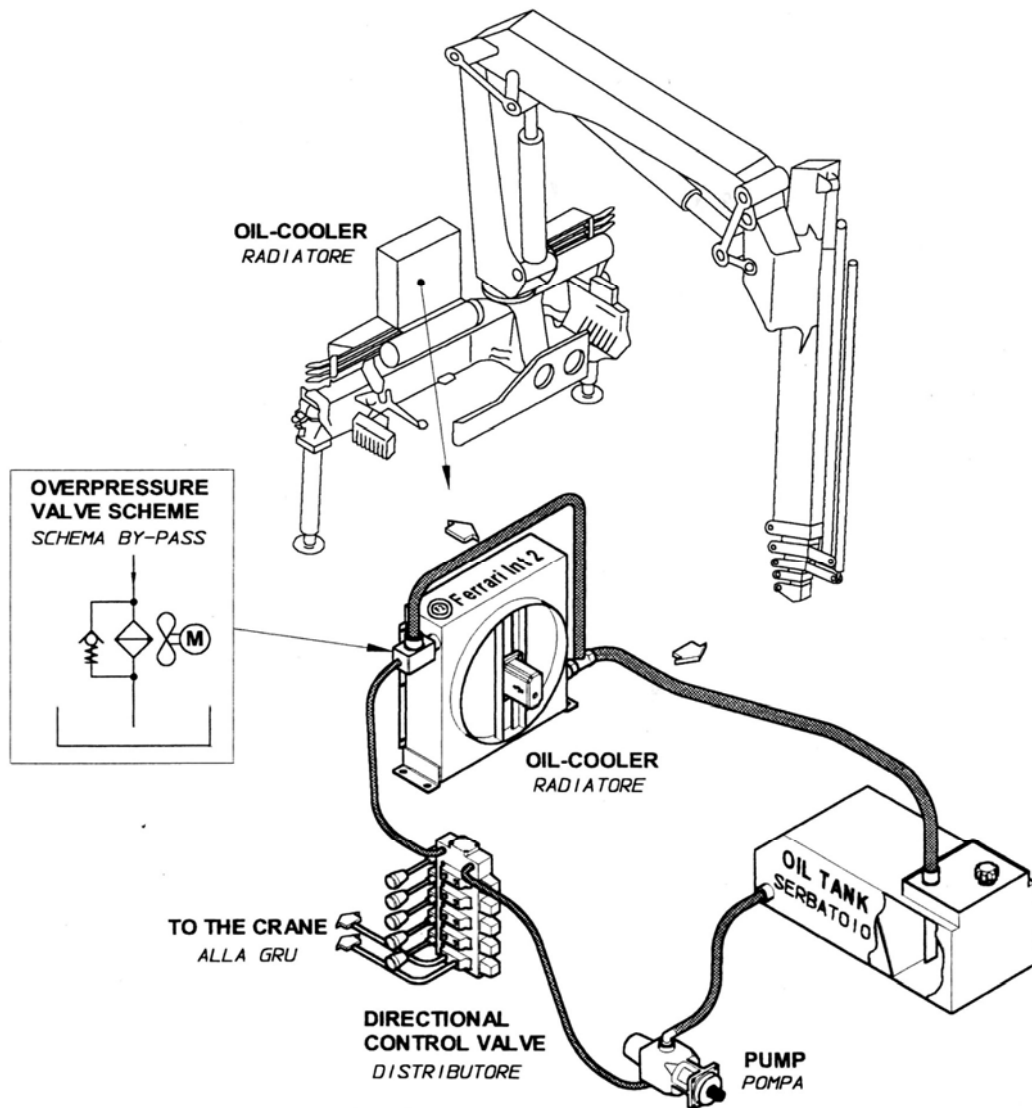

The air/oil coolers available for power packs, hydraulic cranes, excavators and other hydraulic machinery, are equipped with electrical fans of 12 or 24 V and, due to their great stoutness, allow to be installed on all types of machinery, even with the strongest vibrations (in case of aluminium coolers it is better to adopt vibration dumpings).

- **The oil flow** indicated in the leaflet, are suggested for the best performance of the oil cooler.
- **The heat exchange capacity** is expressed in Kcal/h and it is in relation between the oil temperature and the environmental temperature.
- **The loss of pressure**, indicated for each oil cooler does not exceed 1 Bar.
- **The standard temperature of intervention** of the fans is 40-48'. Other settings starting from 30-38' to 50-60' are available on request.
- As a general rule the oil cooler must be installed on the low pressure tank return line. The oil cooler must be mounted in such a way as to ensure that there are no obstacles to the flow of the air, either at the intake or at the outlet of the oil cooler core. In order to achieve the maximum possible rate of exchange it is good practice to ensure that the inlet port is physically lower than the outlet port (see diagram here below).